

P-0050 Coaxial Isolator / Circulator



- * **Compact Design with High Performance**
- * **Custom Connector Configurations (SMA and N type)**
- * **Tab Connector option to interface with PCB**
- * **10W and 25W Termination Options**

Isolator and Circulator versions are available. The connector port configuration can be specified at the time of order, with both sexes of SMA and N type connectors available. The Isolator can be fitted with a 10W or 25W termination. The termination can be fitted to any of the 3 ports. The Tab interface allows direct mounting to a PCB.

Frequency Range	6.4 - 10.5GHz with 20% bandwidth	
Impedance	50 ohm	
Isolation	20dB min.	22dB typ.
VSWR	1.25:1 max.	1.2:1 typ.
Insertion Loss	0.4dB max.	0.35dB typ.
Forward Power	25W CW	
OTR	-10 to +60 degrees Celsius	
Connector Options	SMA, N, Tab (*SMA, N both sexes)	
Termination Options	10W and 25W	
Size	14 x 17 x 14mm(nom. excluding conns.)	
Finish	Brushed Stainless Steel	
Weight	21 grams (nom.)	

P-0050 Series Mechanical Outline

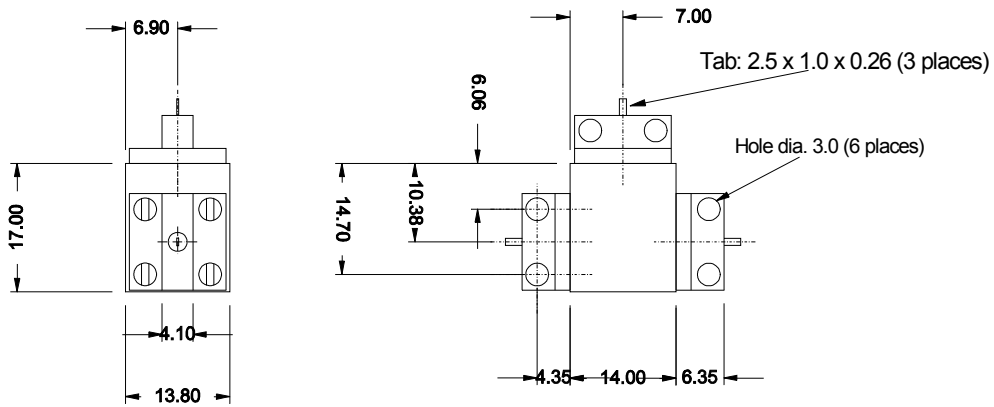

Circulator Fitted with Tab Connectors (Scale 1:1 Dimensions:mm)

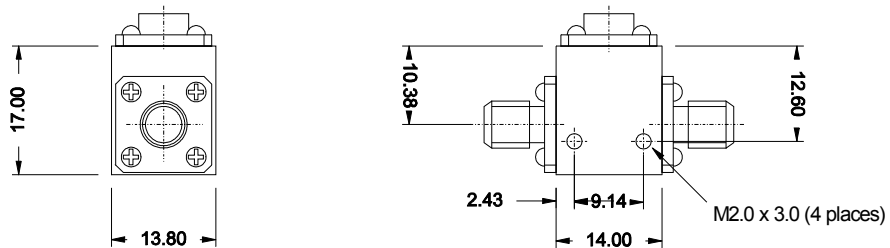

Isolator Fitted with SMA Connectors and 10W Termination (Scale 1:1 Dimensions:mm)